

CHECKED BY:

DRAFTED BY:

CHECKED BY:

DESIGNED BY:

DESIGN SUPERVISOR: M. LAISTNER



Petroleum Pipeline

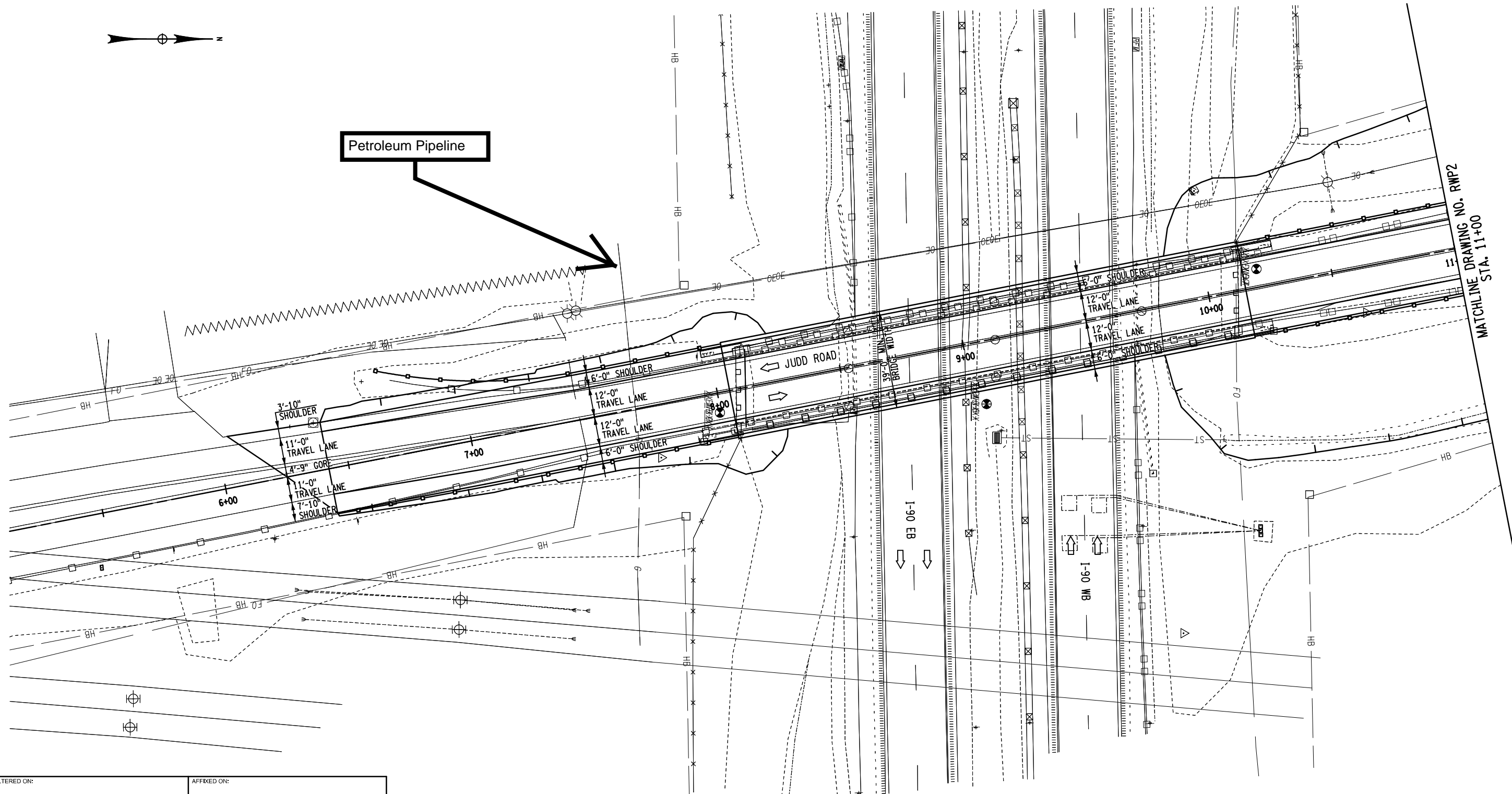
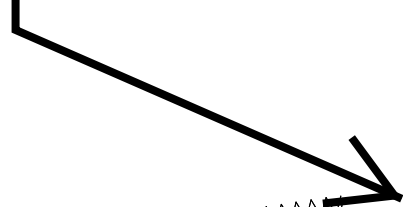

MATCHLINE DRAWING NO. RWP2
STA. 11+00

ALTERED ON:	AFFIXED ON:
SIGNATURE: STAMP:	SIGNATURE: STAMP:

IT IS A VIOLATION OF LAW FOR ANY PERSON, UNLESS THEY ARE ACTING UNDER THE DIRECTION OF A LICENSED PROFESSIONAL ENGINEER, ARCHITECT, LANDSCAPE ARCHITECT, OR LAND SURVEYOR, TO ALTER AN ITEM IN ANY WAY. IF AN ITEM BEARING THE STAMP OF A LICENSED PROFESSIONAL IS ALTERED, THE ALTERING ENGINEER, ARCHITECT, LANDSCAPE ARCHITECT, OR LAND SURVEYOR SHALL STAMP THE DOCUMENT AND INCLUDE THE NOTATION "ALTERED BY" FOLLOWED BY THEIR SIGNATURE, THE DATE OF SUCH ALTERATION, AND A SPECIFIC DESCRIPTION OF THE ALTERATION.

REVISIONS			
DATE	DESCRIPTION	BY	SYM.



TITLE OF PROJECT JUDD ROAD OVER I-90	CONTRACT NUMBER: TAB 17-X
LOCATION OF PROJECT TOWN OF WHITESTOWN ONEIDA COUNTY, NY	DATE: SEPT. 2017
TITLE OF DRAWING ROADWAY PLAN (1 OF 2)	DRAWING NUMBER: RWP1



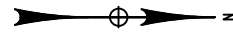

CHECKED BY:

DRAFTED BY:

CHECKED BY:

DESIGNED BY:

DESIGN SUPERVISOR: M. LAISTNER

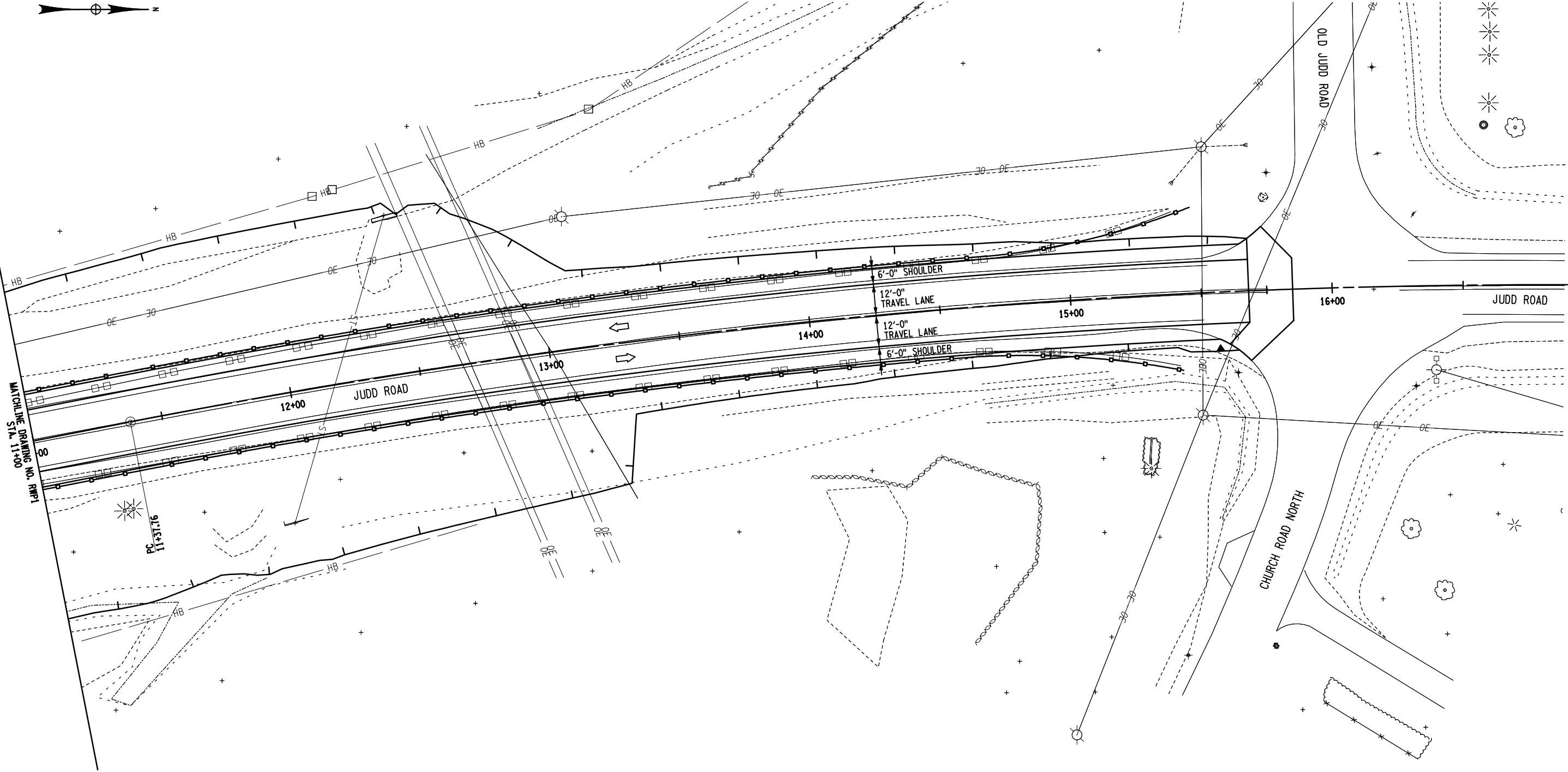

ALTERED ON:	AFFIXED ON:
SIGNATURE: STAMP:	SIGNATURE: STAMP:

IT IS A VIOLATION OF LAW FOR ANY PERSON, UNLESS THEY ARE ACTING UNDER THE DIRECTION OF A LICENSED PROFESSIONAL ENGINEER, ARCHITECT, LANDSCAPE ARCHITECT, OR LAND SURVEYOR, TO ALTER AN ITEM IN ANY WAY. IF AN ITEM BEARING THE STAMP OF A LICENSED PROFESSIONAL IS ALTERED, THE ALTERING ENGINEER, ARCHITECT, LANDSCAPE ARCHITECT, OR LAND SURVEYOR SHALL STAMP THE DOCUMENT AND INCLUDE THE NOTATION "ALTERED BY" FOLLOWED BY THEIR SIGNATURE, THE DATE OF SUCH ALTERATION, AND A SPECIFIC DESCRIPTION OF THE ALTERATION.

REVISIONS			
DATE	DESCRIPTION	BY	SYMBOL



TITLE OF PROJECT	JUDD ROAD OVER I-90
LOCATION OF PROJECT	TOWN OF WHITESTOWN ONEIDA COUNTY, NY
TITLE OF DRAWING	ROADWAY PLAN (2 OF 2)

CONTRACT NUMBER:	TAB 17-X
DATE:	SEPT. 2017
DRAWING NUMBER:	RWP2

CHECKED BY:

DRAFTED BY:

CHECKED BY:

DESIGNED BY:

DESIGN SUPERVISOR: M. LAISTNER

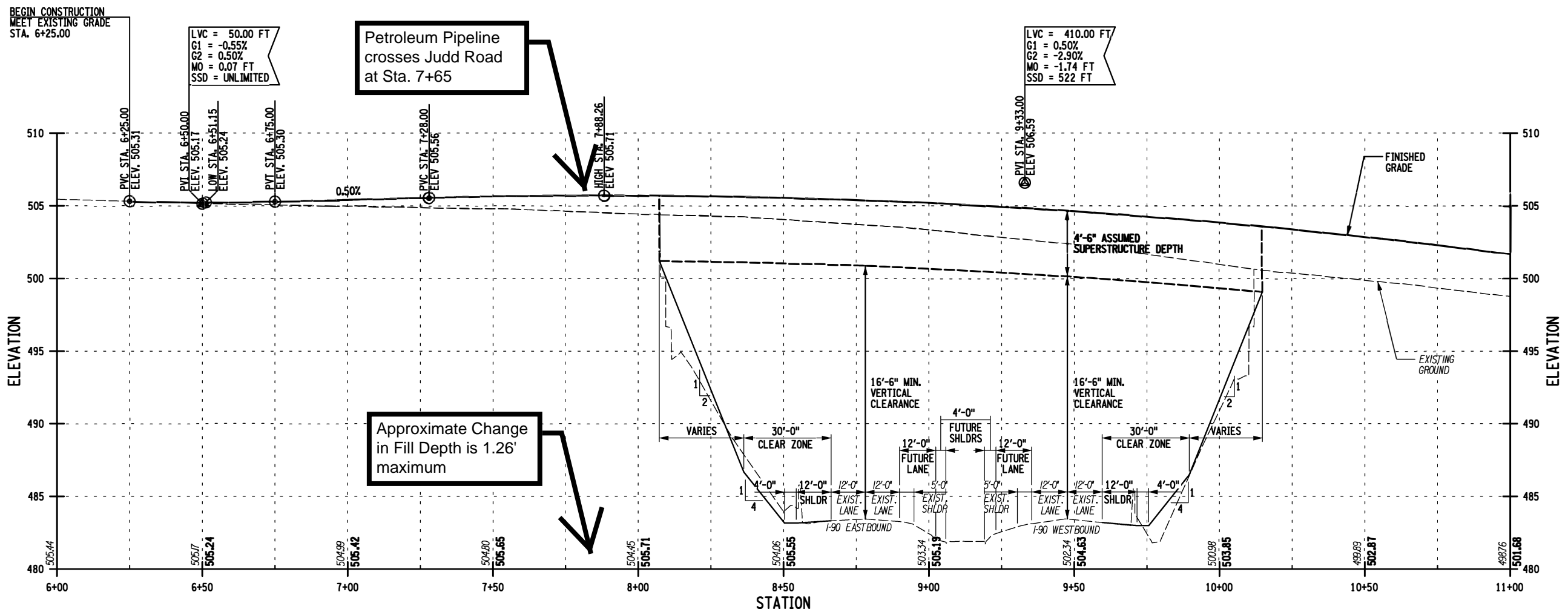

JUDD ROAD PROFILE

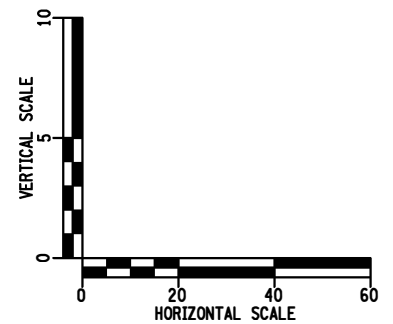

ALTERED ON:	AFFIXED ON:
SIGNATURE: STAMP:	SIGNATURE: STAMP:

IT IS A VIOLATION OF LAW FOR ANY PERSON, UNLESS THEY ARE ACTING UNDER THE DIRECTION OF A LICENSED PROFESSIONAL ENGINEER, ARCHITECT, LANDSCAPE ARCHITECT, OR LAND SURVEYOR, TO ALTER AN ITEM IN ANY WAY. IF AN ITEM BEARING THE STAMP OF A LICENSED PROFESSIONAL IS ALTERED, THE ALTERING ENGINEER, ARCHITECT, LANDSCAPE ARCHITECT, OR LAND SURVEYOR SHALL STAMP THE DOCUMENT AND INCLUDE THE NOTATION "ALTERED BY" FOLLOWED BY THEIR SIGNATURE, THE DATE OF SUCH ALTERATION, AND A SPECIFIC DESCRIPTION OF THE ALTERATION.

REVISIONS			
DATE	DESCRIPTION	BY	SYM.

TITLE OF PROJECT	JUDD ROAD OVER I-90
LOCATION OF PROJECT	TOWN OF WHITESTOWN ONEIDA COUNTY, NY
TITLE OF DRAWING	PROFILE STA. 6+00 TO STA. 11+00 (1 OF 2)

CONTRACT NUMBER:	TAB 17-X
DATE:	JUNE 2017
DRAWING NUMBER:	PRO-1

CHECKED BY:

DRAFTED BY:

CHECKED BY:

DESIGNED BY:

DESIGN SUPERVISOR: M. LAISTNER

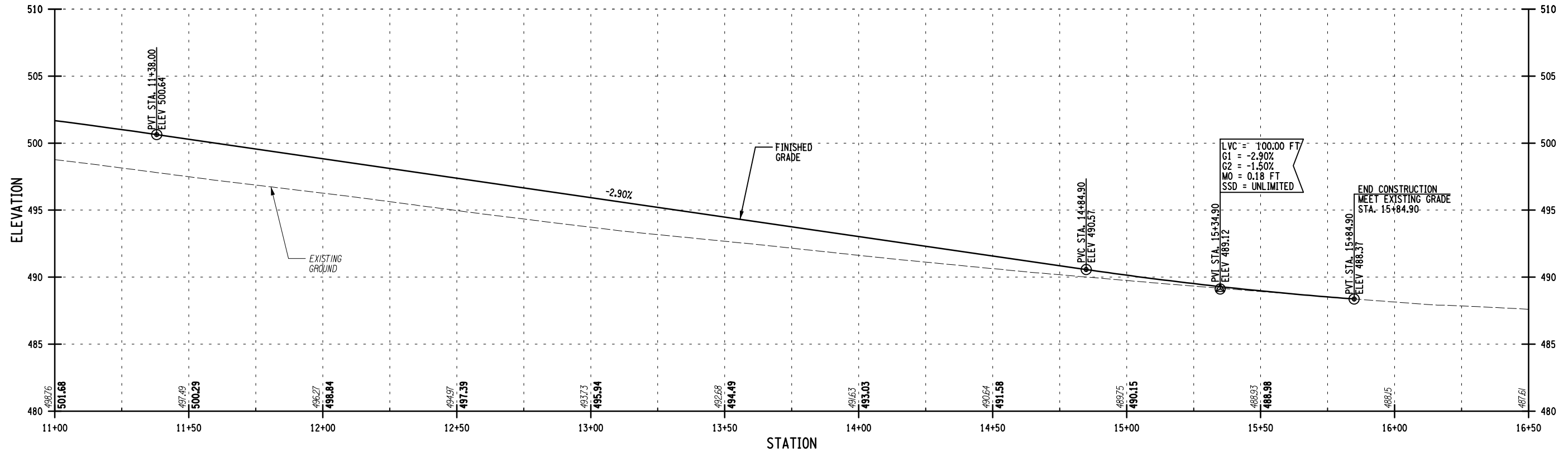

JUDD ROAD PROFILE

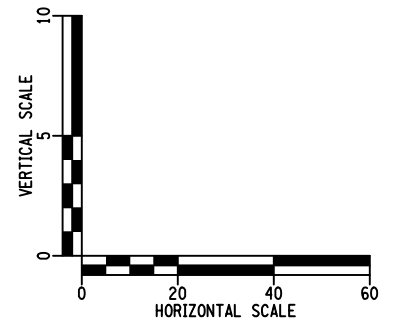

ALTERED ON:	AFFIXED ON:
SIGNATURE: STAMP:	SIGNATURE: STAMP:

IT IS A VIOLATION OF LAW FOR ANY PERSON, UNLESS THEY ARE ACTING UNDER THE DIRECTION OF A LICENSED PROFESSIONAL ENGINEER, ARCHITECT, LANDSCAPE ARCHITECT, OR LAND SURVEYOR, TO ALTER AN ITEM IN ANY WAY. IF AN ITEM BEARING THE STAMP OF A LICENSED PROFESSIONAL IS ALTERED, THE ALTERING ENGINEER, ARCHITECT, LANDSCAPE ARCHITECT, OR LAND SURVEYOR SHALL STAMP THE DOCUMENT AND INCLUDE THE NOTATION "ALTERED BY" FOLLOWED BY THEIR SIGNATURE, THE DATE OF SUCH ALTERATION, AND A SPECIFIC DESCRIPTION OF THE ALTERATION.

REVISIONS			
DATE	DESCRIPTION	BY	SYL

TITLE OF PROJECT	JUDD ROAD OVER I-90
LOCATION OF PROJECT	TOWN OF WHITESTOWN ONEIDA COUNTY, NY
TITLE OF DRAWING	PROFILE STA. 11+00 TO STA. 16+50 (2 OF 2)

CONTRACT NUMBER:	TAB 17-X
DATE:	APRIL 2017
DRAWING NUMBER:	PRO-2

CHECKED BY:

DRAFTED BY:

CHECKED BY:

DESIGNED BY:

DESIGN SUPERVISOR: M. LAISTNER

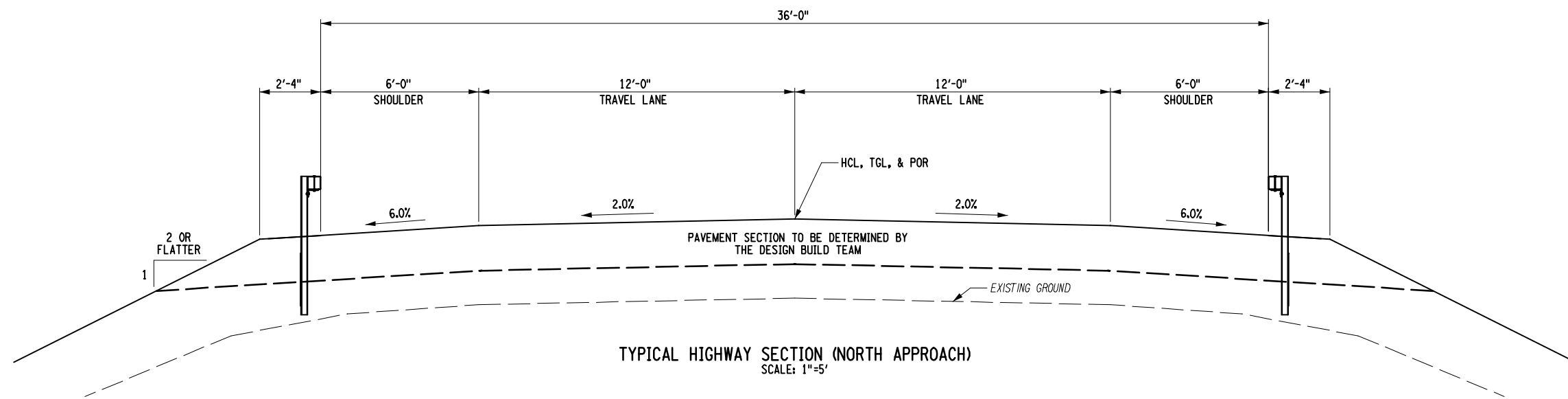
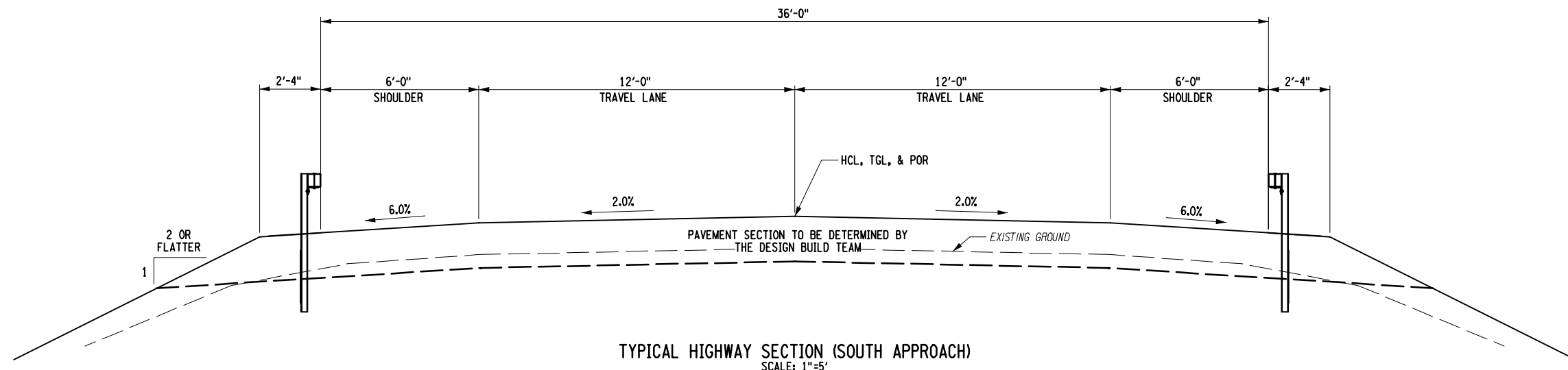

ALTERED ON:	AFFIXED ON:
SIGNATURE: STAMP:	SIGNATURE: STAMP:

IT IS A VIOLATION OF LAW FOR ANY PERSON, UNLESS THEY ARE ACTING UNDER THE DIRECTION OF A LICENSED PROFESSIONAL ENGINEER, ARCHITECT, LANDSCAPE ARCHITECT, OR LAND SURVEYOR, TO ALTER AN ITEM IN ANY WAY. IF AN ITEM BEARING THE STAMP OF A LICENSED PROFESSIONAL IS ALTERED, THE ALTERING ENGINEER, ARCHITECT, LANDSCAPE ARCHITECT, OR LAND SURVEYOR SHALL STAMP THE DOCUMENT AND INCLUDE THE NOTATION "ALTERED BY" FOLLOWED BY THEIR SIGNATURE, THE DATE OF SUCH ALTERATION, AND A SPECIFIC DESCRIPTION OF THE ALTERATION.

REVISIONS			
DATE	DESCRIPTION	BY	SYL.

TITLE OF PROJECT JUDD ROAD OVER I-90
LOCATION OF PROJECT TOWN OF WHITESTOWN ONEIDA COUNTY, NY
TITLE OF DRAWING TYPICAL HIGHWAY SECTIONS

CONTRACT NUMBER: TAB 17-X
DATE: JUNE 2017
DRAWING NUMBER: TYP-1

CHECKED BY: M. SAVINO

DRAFTED BY: K. SHAH

CHECKED BY: M. SAVINO

DESIGNED BY: K. SHAH

DESIGN SUPERVISOR: M. LAISTNER

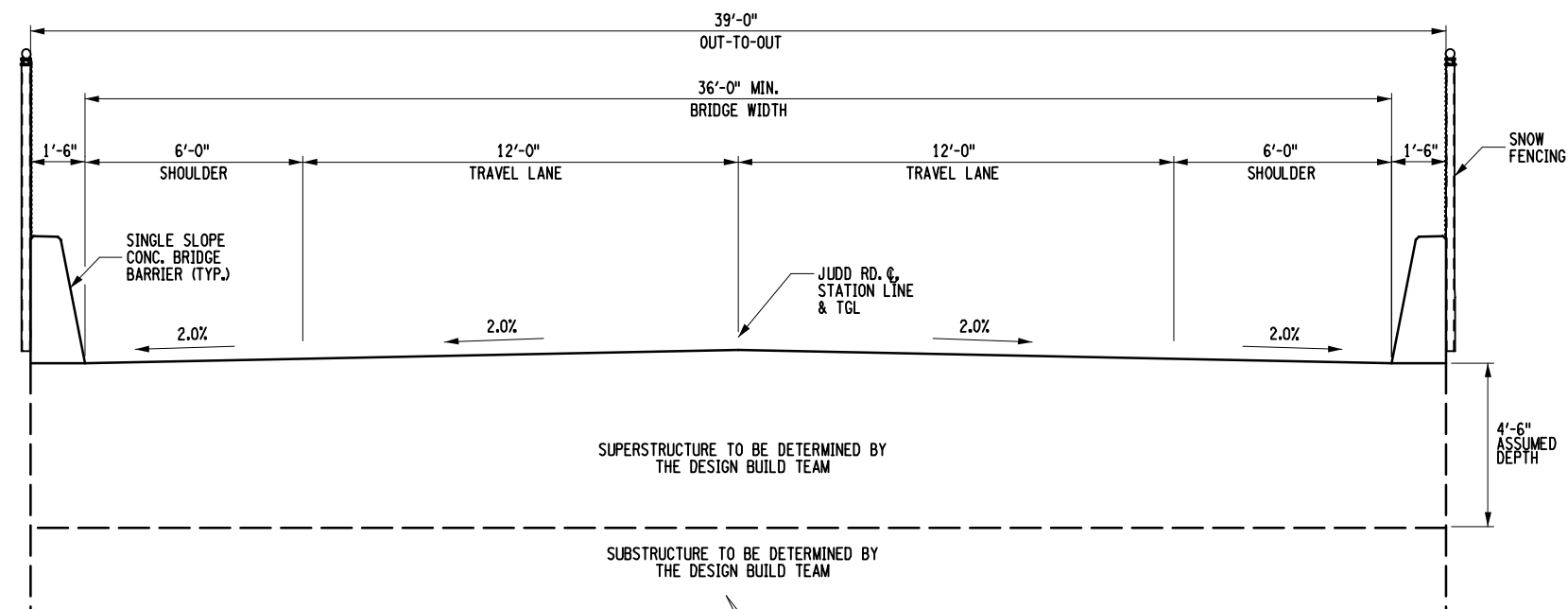

PROPOSED TYPICAL BRIDGE SECTION
SCALE 1" = 5'-0"

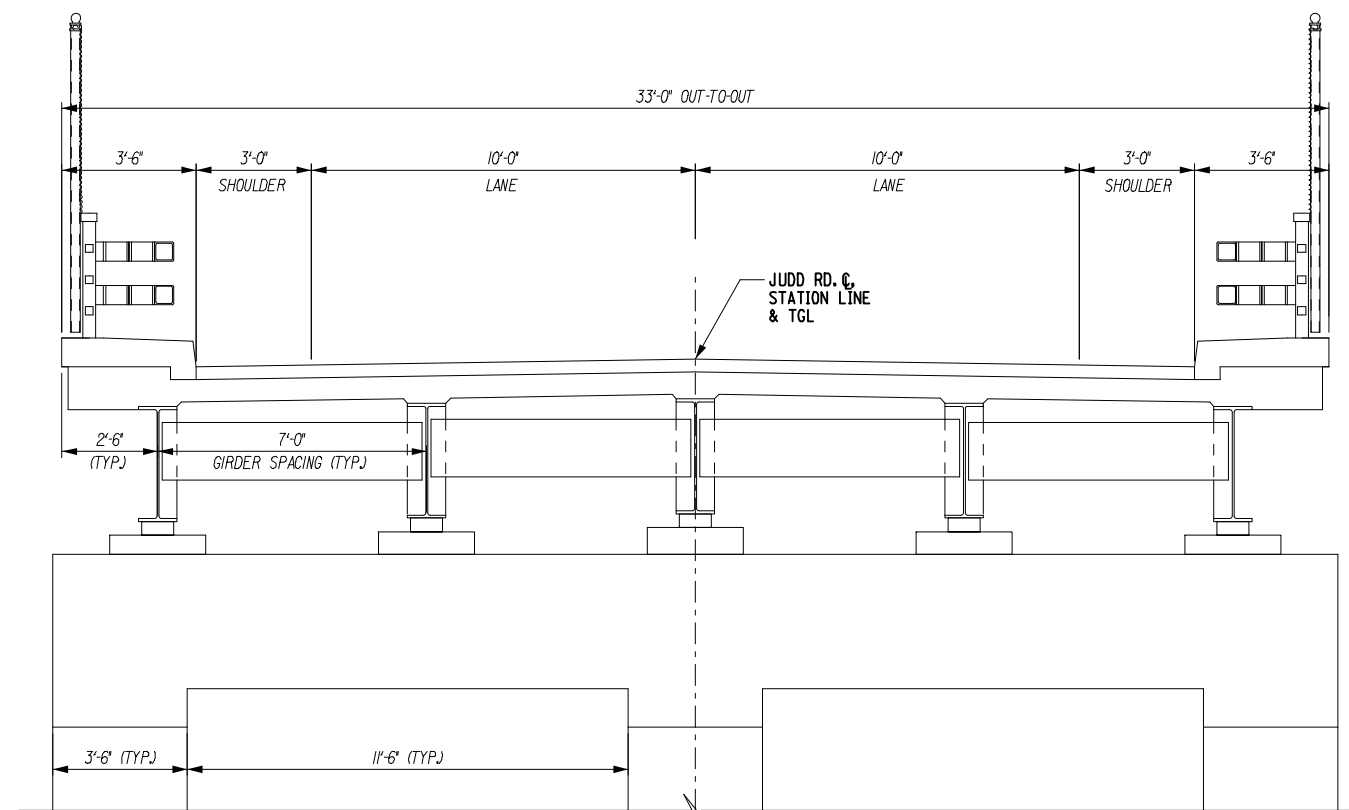

EXISTING TYPICAL BRIDGE SECTION
SCALE 1" = 5'-0"

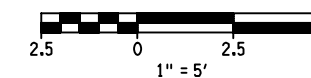

ALTERED ON:	AFFIXED ON:
SIGNATURE: STAMP:	SIGNATURE: STAMP:

IT IS A VIOLATION OF LAW FOR ANY PERSON, UNLESS THEY ARE ACTING UNDER THE DIRECTION OF A LICENSED PROFESSIONAL ENGINEER, ARCHITECT, LANDSCAPE ARCHITECT, OR LAND SURVEYOR, TO ALTER AN ITEM IN ANY WAY. IF AN ITEM BEARING THE STAMP OF A LICENSED PROFESSIONAL IS ALTERED, THE ALTERING ENGINEER, ARCHITECT, LANDSCAPE ARCHITECT, OR LAND SURVEYOR SHALL STAMP THE DOCUMENT AND INCLUDE THE NOTATION "ALTERED BY" FOLLOWED BY THEIR SIGNATURE, THE DATE OF SUCH ALTERATION, AND A SPECIFIC DESCRIPTION OF THE ALTERATION.

REVISIONS			
DATE	DESCRIPTION	BY	SYM.



TITLE OF PROJECT	JUDD ROAD OVER I-90	CONTRACT NUMBER:	TAB 17-X
LOCATION OF PROJECT	TOWN OF WHITESTOWN ONEIDA COUNTY, NY	DATE:	JUNE 2017
TITLE OF DRAWING	TYPICAL BRIDGE SECTIONS	DRAWING NUMBER:	TYP-2